

# HYATT LODGE

AT McDONALD'S CAMPUS

2815 JORIE BOULEVARD  
OAK BROOK, IL 60523

T + (630) 568 1234

F + (630) 581 6619

thelodge.hyatt.com



*you're more than welcome*

2012.11

## Accommodations

- 218 guestrooms consisting of: Suites, Parlors, Kings, and Double Queen Rooms
- Seven ADA Accessible Rooms
- Hyatt Grand Bed™
- Turndown service available upon request
- High Definition LCD flat-screen television
- Video messages, video account review, video checkout
- Voice mail and telephone with message light
- Full bath amenities and hair dryer
- iHome® alarm clock radio
- Iron / ironing board and individual climate control
- In-room safe
- Coffeemaker and mini refrigerator
- Hardwood Entry Floor

## Conferences & Banquets

- A total of 47,000 sq. feet of function space
- 5,100 sq. feet ballroom and 3,800 sq. feet Grand Oaks Pavilion
- Connected to McDonald's Conference Center, Hamburger University, featuring 33, 210 sq. feet of meeting space including a 299-seat auditorium, and two tiered classrooms that accommodate 110 people each.
- All 44 meeting rooms feature individual or master controls for heat / AC and sound; telephones; multiple electrical / microphone outlets
- Dirk Lohan designed Prairie-style architecture in a retreat-like setting

## Location

Discover a private retreat in the heart of Oak Brook, IL. The Hyatt Lodge at McDonald's Campus offers exceptional amenities in an unparalleled natural setting.

## Directions

From O'Hare Int'l Airport (15 miles): Take I-294 South to I-88 West. Exit I-88 at 83 North (Cermak Rd)-1st exit after toll booth. At stoplight (22nd St / Cermak Rd), turn right and go two stoplights to Jorie Blvd. Turn right on Jorie Blvd to the third stoplight (Kroc Dr). Turn left. At stop sign turn left on Ronald Lane. Hotel is on left.

## Points of Interest

- Oak Brook Shopping Center
- Oak Brook Golf Course
- Brookfield Zoo
- Morton Arboretum
- Riverboat Casinos
- Drury Lane Theatre
- Frank Lloyd Wright Home & Studio
- Graue Mill and Museum
- Yorktown Center Mall
- Pinstripes Bowling and Bocce Ball Facility

## Services & Facilities

- Hyatt Express Check-in Kiosks
- Hyatt Fast Board™
- Self-service Business Center
- Assistive devices for persons with disabilities
- Valet services and parking
- Multilingual staff, Currency exchange, and ATM
- Safe-Deposit Boxes
- Gift Shop / Vending area with microwaves

## Restaurant, Bar & Lounge

- **PIAZZA** — Upscale dining experience featuring Mediterranean infused Italian Cuisine
- **WATER'S EDGE** — Casual marketplace café concept restaurant
- **HEARTH LOUNGE** — Serving cocktails and appetizers
- **IN ROOM DINING** — Dine in the comfort of your guest room

## Recreational Facilities

- **MIDTOWN FITNESS CENTER** — includes state-of-the-art cardiovascular equipment, weight training, aerobics, and personal trainers
- **MIDTOWN SPA** — specializes in spa manicures, pedicures and extensive massage therapy services
- **INDOOR POOL** — 70-foot lap pool designed for water sports; three whirlpools; sauna and steam-room
- Team Challenge Adventure Course
- Complimentary Bicycles (Seasonally Available)
- Four miles of jogging trails and five hiking / biking paths

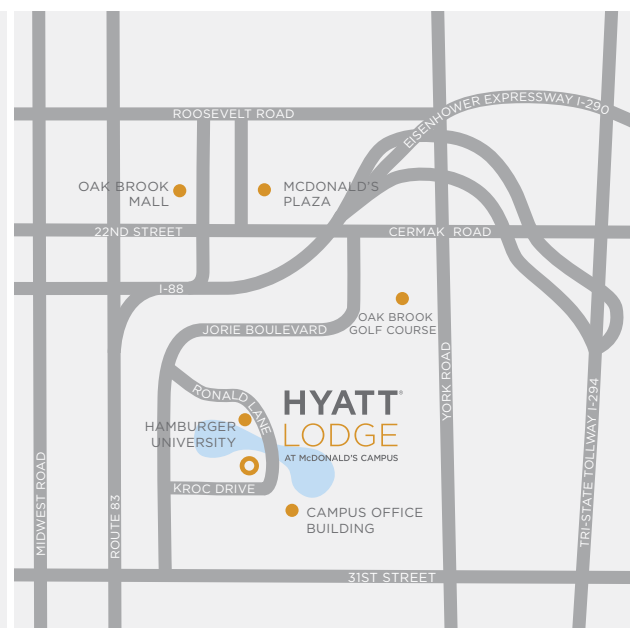

# HYATT LODGE

AT McDONALD'S CAMPUS

2815 JORIE BOULEVARD  
OAK BROOK, IL 60523

T + (630) 568 1234

F + (630) 581 6619

thelodge.hyatt.com



*you're more than welcome*

2012.11

## Hyatt Lodge Floorplans

### BALLROOM LEVEL

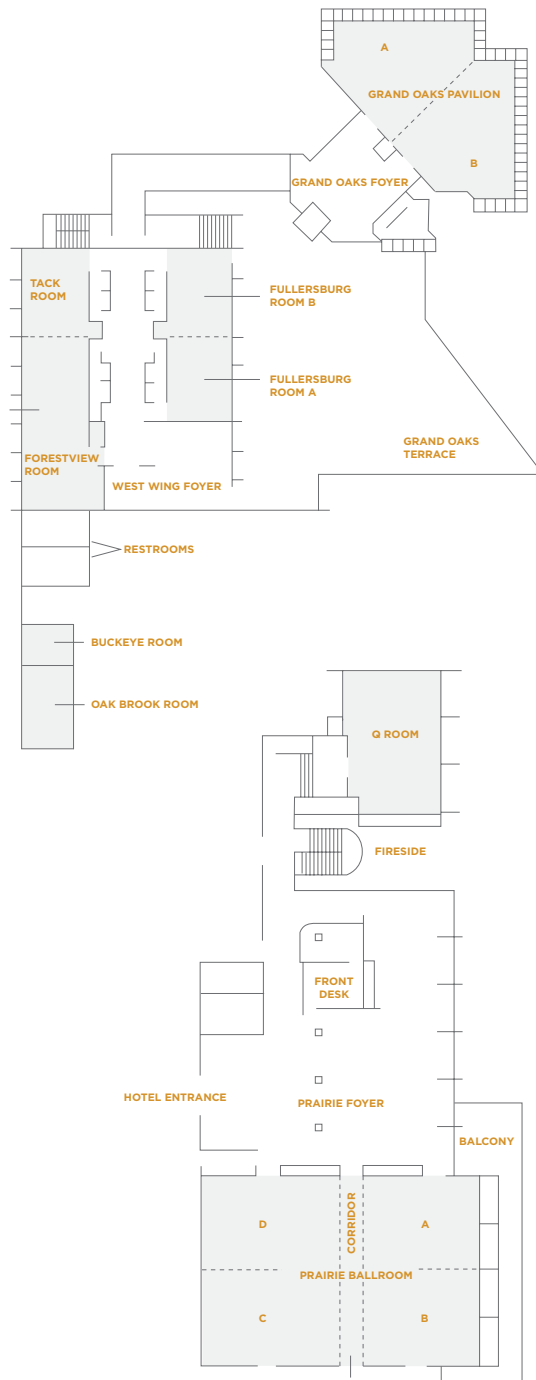

# HYATT LODGE

AT McDONALD'S CAMPUS

2815 JORIE BOULEVARD  
OAK BROOK, IL 60523

T + (630) 568 1234

F + (630) 581 6619

thelodge.hyatt.com



*you're more than welcome*

2012.11

## Hyatt Lodge Room Capacities & Dimensions



Room Name	Room Dimensions L x W x H	Room Size Sq. Ft.	Banquet	Reception	Theater	Classroom	Boardroom	U-Shape	Hollow Square	Table Top Exhibit
<b>BALLROOM LEVEL</b>										
Prairie Ballroom	58' x 88' x 14'6"	5,104	350	450	500	300	—	—	—	50
Prairie A + B + Corridor	58' x 47' x 14'6"	2,726	150	250	250	144	—	—	—	40
Prairie C + D Corridor	58' x 47' x 14'6"	2,726	150	250	250	144	—	—	—	40
Prairie A + B or C + D	40' x 58' x 14'6"	2,320	150	225	200	115	—	56	68	20
Prairie A, B, C, or D	40' x 29' x 14'6"	1,160	60	100	100	40	30	30	38	10
Prairie Foyer	64' x 30' x 12'	1,920	100	—	—	—	—	—	—	15
Q Room	38' x 28' x 12'	1,064	70	100	70	40	20	20	24	8
Forestview Room	51' x 24' x 8'	1,224	70	125	115	55	55	50	55	10
Fullersburg Room A + B	53' x 21' x 8'	1,113	70	125	115	55	55	50	55	10
Fullersburg Room A or B	26' x 21' x 8'	546	30	30	30	18	20	15	20	4
Tack Room	21' x 24' x 8'	504	30	30	30	18	20	15	20	4
Buckeye Room	12' x 26' x 8'	312	—	—	—	—	8	—	—	—
Oak Brook Room	16' x 26' x 8'	416	—	—	—	—	16	—	—	—
Grand Oaks Pavilion	96' x 108' x 12'	3,800	200	250	200	125	—	—	—	20
Grand Oaks Pavilion A	55' x 53' x 12'	1,900	100	125	75	—	—	—	—	10
Grand Oaks Pavilion B	41' x 55' x 12'	1,900	100	125	75	—	—	—	—	10
Grand Oaks Foyer	80' x 40' x 12'	3,200	40	—	—	—	—	—	—	5
West Wing Foyer	21' x 24' x 8'	504	30	—	—	—	—	—	—	3
Fireside	26' x 24' x 20'	—	30	30	—	—	—	—	—	—

# HYATT LODGE

AT McDONALD'S CAMPUS

2815 JORIE BOULEVARD  
OAK BROOK, IL 60523

T + (630) 568 1234  
F + (630) 581 6619

thelodge.hyatt.com



*you're more than welcome*

2012.11

## Hamburger University Floorplans

### FIRST LEVEL

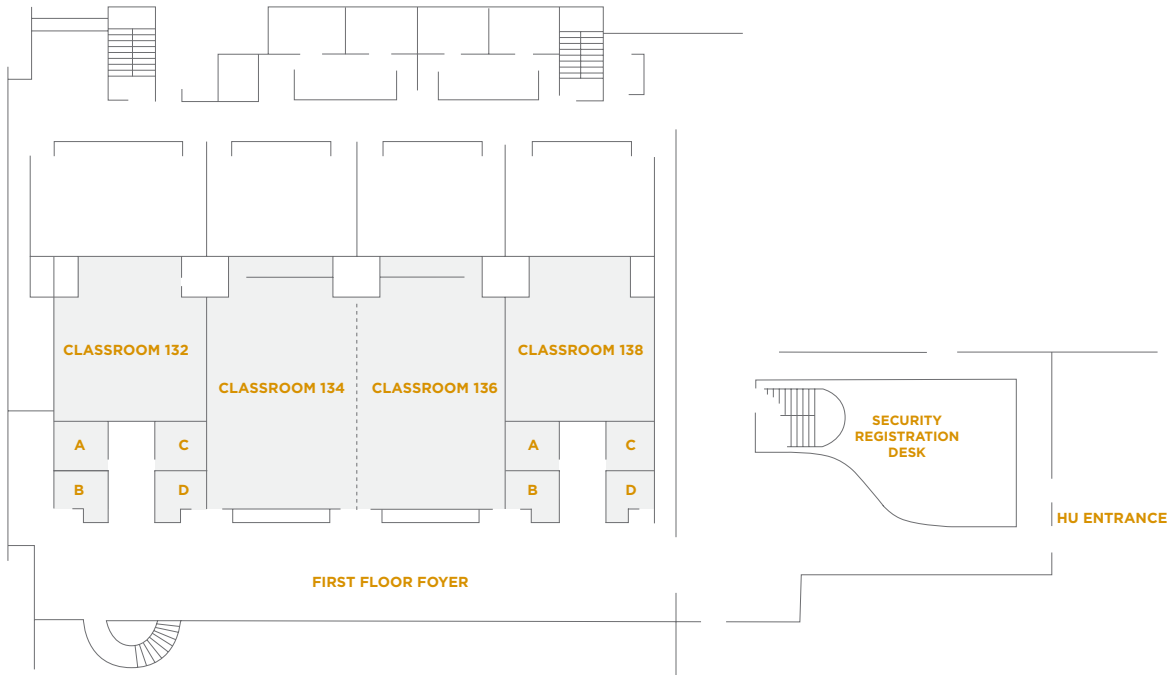

## Hamburger University Floorplans

### SECOND LEVEL

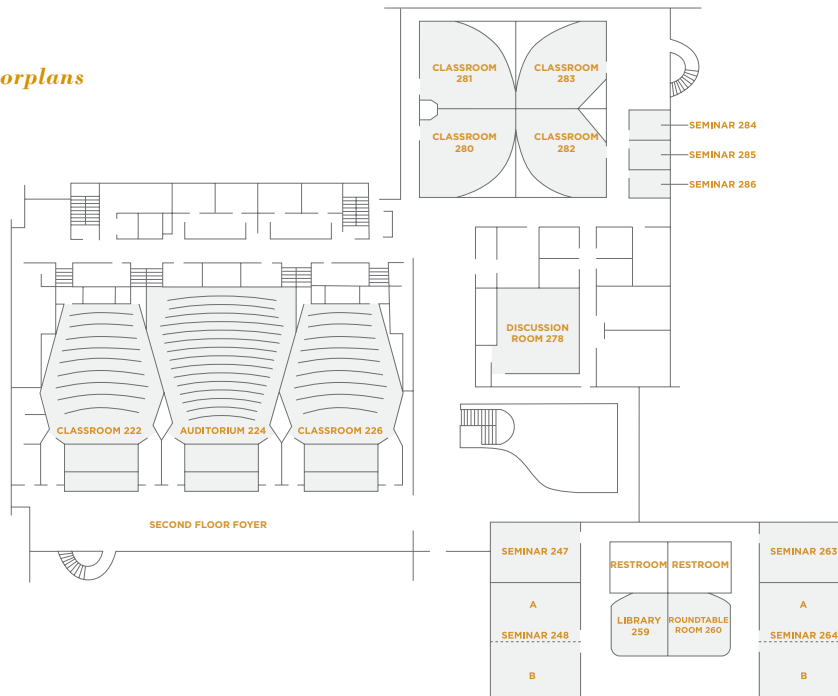



*you're more than welcome*

2012.11

## Room Capacities & Dimensions



Room Name	Room Dimensions L x W x H	Room Size Sq. Ft.	Banquet	Reception	Theater	Classroom	Boardroom	U-Shape	Hollow Square	Table Top Exhibit
<b>HAMBURGER UNIVERSITY (FIRST LEVEL)</b>										
SMART Classrooms* 132 / 138	36' x 42' x 9'	1,512	—	—	—	—	—	—	—	—
Classroom 132 A, B, C or D	14' x 11' x 9'	154	—	—	—	—	6	—	—	—
Classroom 138 A, B, C or D	14' x 11' x 9'	154	—	—	—	—	6	—	—	—
Classroom 134 / 136	36' x 56' x 9'	2,016	100	125	150	90	—	45	50	11
Classroom 134 + 136	72' x 56' x 9'	4,032	200	250	250	110	40	45	60	22
First Floor Foyer	—	—	100	—	—	—	—	—	—	12

## HAMBURGER UNIVERSITY (SECOND LEVEL)

Tiered Classroom 222 or 226	48' x 56' x 15'10"	2,260	—	—	—	120	—	—	—	—
Tiered Auditorium 224	59' x 62' x 15'10"	2,880	—	—	299	—	—	—	—	—
Seminar 247 / 248 A or B	24' x 32' x 9'	768	40	—	—	25	20	20	25	—
Seminar 248 / 264 A + B	32' x 32' x 9'	1,536	80	80	100	50	30	36	30	10
Roundtable Room 260	22' x 26' x 9'	572	—	—	—	—	15	—	—	—
Seminar 263 / 264 A or B	24' x 32' x 9'	768	40	—	—	25	20	20	25	—
Discussion Room 278	32' x 34' x 15'	1,088	60	—	75	40	—	30	—	10
SMART Classrooms* 280 / 281 / 282 / 283	36' x 36' x 9'	1,296	—	—	—	—	—	—	—	—
Seminar 284 / 285 / 286	14.5' x 14.5' x 9'	166.75	—	—	—	—	6	—	—	—
Library 259	22' x 26' x 9'	572	—	—	25	15	10	15	—	—
Second Floor Foyer	—	—	100	—	—	—	—	—	—	14

### Notes:

The SMART Classrooms are a permanent set of team tables to accommodate a maximum of 36 people. The SMART rooms are pre-set with six Mediascape tables and monitors for interactive collaboration sessions.